

Plan parcelar T 117, T 11
 UAT Soars

Tarla 117: A 3662/1, A 3662/2, A 3662/4, A 3662/5, A 3662/6, A 3662/7, A 3662/8, A 3662/9, DE 3662/3/1, DE 3662/3/2, DE 3664/1, CCN 3663
 Tarla 110: A 3353/1, A 3353/2, A 3353/3, A 3358/1/1, A 3358/1/2, A 3358/1/3, CCN 3358/2
 COPIE SPRE PUBLICAR

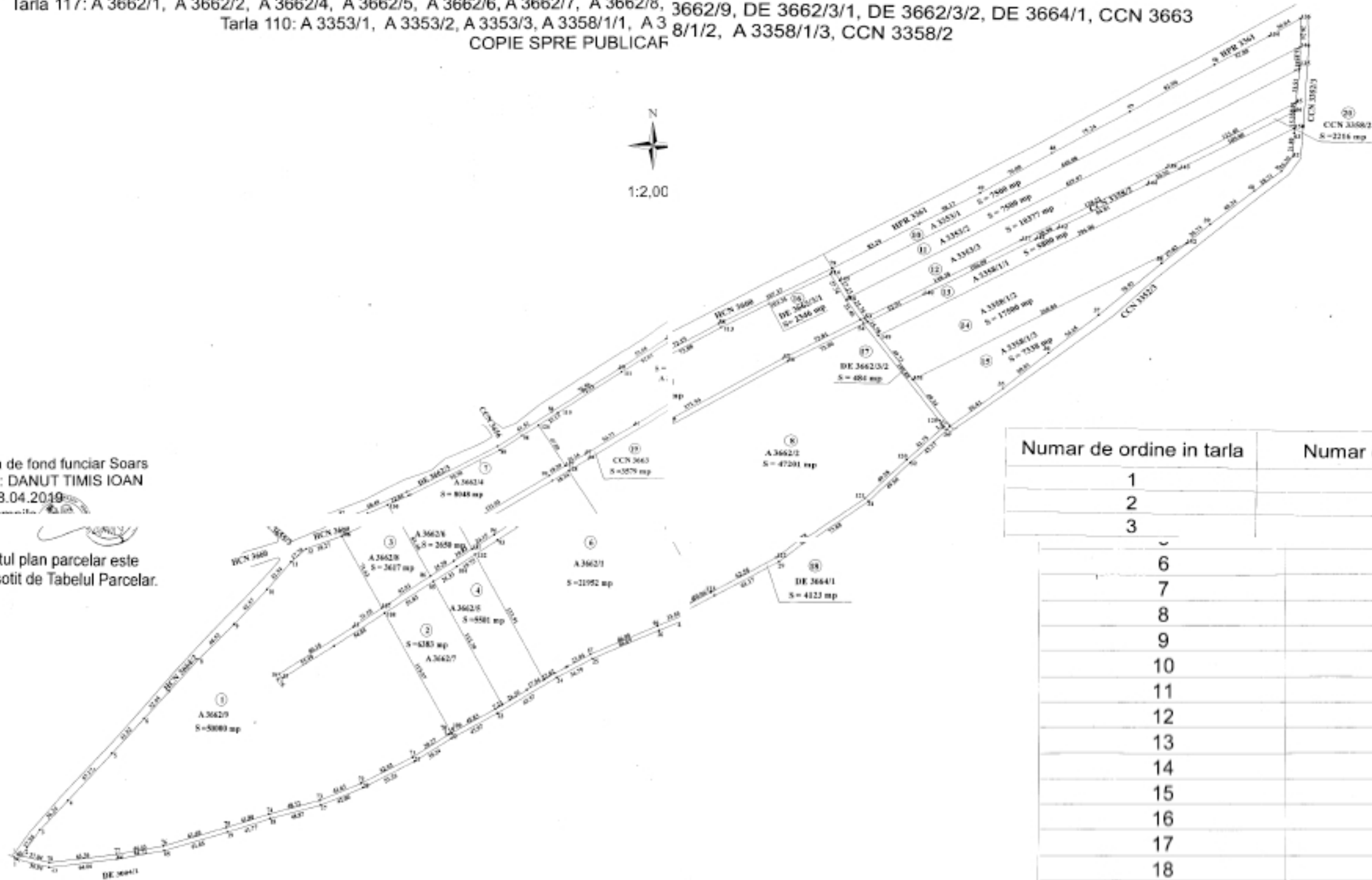

Vizat Comisia locala de fond funciar Soars
 Presedinte comisie: DANUT TIMIS IOAN
 Data: 18.04.2019



Prezentul plan parcelar este
 valabil insotit de Tabelul Parcelar.

| Numar de ordine in tarla | Numar cadastral atribuit |
|--------------------------|--------------------------|
| 1 | |
| 2 | |
| 3 | |
| 4 | |
| 5 | |
| 6 | |
| 7 | |
| 8 | |
| 9 | |
| 10 | |
| 11 | |
| 12 | |
| 13 | |
| 14 | |
| 15 | |
| 16 | |
| 17 | |
| 18 | |
| 19 | |
| 20 | |

Se confirma suprafata din masur
 imobilul in baza de plan se introduce

Stamps and signatures:
 Parafa
 Semna
 lata
 Stampi

Executant: Ing. Cosmin Belean
 Data: 14.12.2018

